



Webex on Flip

Samsung Flip with Cisco Webex Room Kit Mini

Future of work. On display.

Collaboration is the foundation for success in today's fast-paced business world. Industry leaders Samsung and Cisco have come together to transform the modern workplace with Webex on Flip. The partnership unites Cisco's innovative Webex collaboration platform with leading Samsung signage technology, providing a seamless, integrated meeting experience.

Interactive features make the Flip a powerful collaboration tool. And when combined with Cisco's leading video conferencing technology, people can come together whether in a meeting room or working remotely from multiple locations. This is the future of work, on display.

Highlights

- Enable flexible utilization of both video conferencing and digital flipchart as needed
- Utilize useful features for whiteboarding including pen-to-paper-like writing experience, and various edit tools
- Foster more productive and engaging collaboration in any business setting to get things done
- Facilitate smoother video conferencing through crystal-clear audio and detailed picture quality
- Use together with Webex Teams to support a better workflow
- Share and source content from multiple connected devices

SAMSUNG

Cisco Webex

Future of work. On display.

Experience integrated meeting solution



Why Webex on Flip?

By aligning leading visual display technologies from Samsung with Cisco's leading video collaboration solutions, together, this professional offering transforms the modern meeting space. Today's professionals cannot afford to lose valuable time by struggling with complicated technology. The Samsung and Cisco solutions help eliminate these challenges through a convenient and intuitive operational flow. Bringing together a comprehensive suite of features which meets the needs of people who want to use a digital flipchart rather than analog to upgrade their meeting environment. Webex on Flip unites the innovative interactive digital flipchart technology from Samsung and Cisco's advanced meeting solution to enable more accessible meetings and creative collaboration.

Cisco Webex Room Kit



Webex Room Kit Mini



Samsung Flip



Flip 55"



Flip 65"

What is Cisco Webex Room Kit Mini?

The Cisco Webex Room Kit Mini is a compact video conferencing and collaboration device optimized for huddle space and small meeting rooms. Combined with a flat-panel displays, it brings people together to collaborate across any distance. Equipped with multiple sensors and AI-power features Cisco Webex Room Kit Mini provides intelligent ease of use to allow you to focus on your meeting, and support your needs whether it is to share a presentation, join an audio or video conference or create content together with your team members locally, in the room or remotely. Combined with the Webex Teams application you can easily move your meeting between your personal device and the Room Kit Mini for a better huddle space experience.

Features

Cisco Webex



Smart meetings

Intelligent camera and audio solutions secure optimal framing with high quality video and suppress background noises for an optimal audio experience.



Smart presentations

Support for both wired and wireless sharing and 4K content make for effective presentations.



Smart integrations

Monitor meeting space utilization and integrate with other facility service for a better workplace experience.



Access to Webex service

Through Room Kit Mini, you can access Webex calling, Webex Meetings, Whiteboard service, Webex Teams spaces, Remote Management and Room Utilization analytics.

What is Samsung Flip?

The Samsung Flip is an intuitive and easy-to-use digital flipchart for virtually any meeting environment, offering enhanced collaboration capabilities in an easy UI with a host of features and tools. Meetings are made smarter through simple notation modes, flexible image editing, comprehensive connectivity options and screen sharing capability, allowing teams to work smarter, faster and better.

Features

SAMSUNG



Pen & paper annotation

InGlass technology ensures a smooth and familiar pen-to-paper-like writing with no delay, while users can easily erase drawings with a finger or palm swipe.



Intuitive usability

Write on any background source without affecting work behind the original layer, scroll through up to 20 pages and merge any image to the roll at the click of a button.



Convenience

Effortless presentations supported by any web browser, embedded versatile templates as well as a document viewer without additional PC.

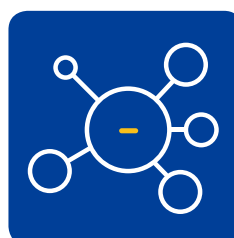

Powerful connectivity

USB, HDMI, NFC and screen mirroring capabilities for versatile connectivity, together with screen sharing and meeting recap distribution.

Samsung and Cisco Webex offer solutions for smarter collaboration

Samsung and Cisco Webex together provide businesses with optimal meeting room solutions to create a connected and collaborative experience. With Webex on Flip, all users will have a smooth conference experience in crisp, vibrant clarity. Collaboration is the core focus of Webex on Flip, allowing multiple meeting participants to share the screen in real-time and create the most efficient meetings possible.



Perfect video conferencing solution

Cisco's Webex Room Kit Mini provides important video and audio-conferencing features for intelligent meeting experience. AI-powered capabilities provide a more convenient way of communicating by automatically positioning the face of meeting participants in the center of the screen, while background noise suppression ensures a smooth video conference experience with no delay.

Multi-way collaboration

Webex on Flip enables real-time, 2-way white boarding, allowing meeting participants in different locations to share the same screen and make edits. Users can utilize the annotation tool, delete or add content, all at the same time creating more efficient and collaborative meetings.

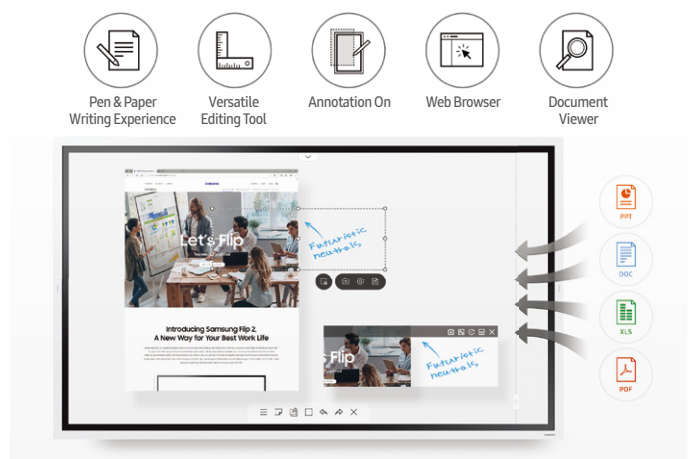

Wireless presentation

Webex on Flip allows users to utilize their own laptop or mobile with a wireless connection to easily share content with others. This ensures intuitive and convenient operation without the need for any additional hardware or technical difficulties.



Leading digital flipchart

The Flip has a host of innovative features for the needs of any meeting environment. Users can feel a smooth pen-to-paper-like writing experience and easily change content with the editing and annotation tools, all supported by access to a web browser directly on the Flip without needing any additional device or document viewer for comprehensive functionality.

Specification

| Model | Webex Room Kit Mini | |
|----------------------------------|--|--|
| |  | |
| Recommended meeting room type | Designed for huddle space, typical 5 seat scenario | |
| Collaboration capabilities | Video/Web conference Audio conference Wired/wireless presentation Multi-way Whiteboarding | |
| Intelligent meeting capabilities | Auto wakeup One Button to Join Optimal camera framing Background noise suppression Auto pairing of personal devices Voice Assistant | |
| Codec | Built-in HW components | Codec, Camera, Speakers, Microphones |
| | Compute / codec HW | Embedded appliance for video conferencing / H.323, SIP, Webex |
| | Software compatibility | Cisco Webex Room OS Cisco Collaboration Endpoint SW - CE 9.6 or later |
| | Video standards and definition | H.264 / up to 1080p60 |
| | Audio standards and quality | G.711, G.722, G.722.1, G.729, AAC-LD, Opus / 20kHz Audio |
| | Content standards and definition | H.239, BFCP / up to 4kp5 |
| | Wireless sharing | Webex Teams/Meetings App / up to 4kp5 |
| Camera | Sensor resolution | 4K UltraHD |
| | Field of view | 120° Horizontal |
| | Zoom | 2x (Digital) |
| Microphone | Built-in microphone array | |
| Speakers | Built-in full range speaker + dual woofers | |
| Connectivity | 1x HDMI Video input 1x HDMI Video output 2x Ethernet 1x USB 2.0 A 1x USB 2.0 C 1x micro USB WiFi 802.11, 2.4GHz/5GHz | |
| Dimensions | 19.7 x 3.2 x 3 inch 50.0 x 8.1 x 7.7 cm 7lb / 3.2 kg | |

| Collaboration platform | Webex Cloud Services |
|--|-------------------------------|
| Voice calls / Audio conferencing | Webex Calling |
| Video and Web conferencing | Webex Meetings |
| Team collaboration, incl. Meetings / IM / Spaces / Whiteboarding / Files | Webex Teams |
| Users and Device Management and provisioning | Webex Control Hub |
| Scheduling and calendar integration | Webex Hybrid Calendar Service |

| Model | WM55R | WM65R | | |
|--------------------------|---|---|--|--------------------------------|
| |  |  | | |
| Panel | Diagonal Size | 55" | 65" | |
| | Type | 60Hz New Edge | | |
| | Resolution | 3,840 x 2,160 (Landscape) | | |
| | Brightness (Typ.) | 350 (without glass), 220 (with glass) | | |
| | Contrast Ratio (Typ.) | 4000:1 (Typ.) (without glass) | | |
| | Viewing Angle (H/V) | 178:178 | | |
| | Operation Hour | 16/7 | | |
| Response Time (G-to-G) | 8ms (Typ.) | | | |
| Sound | Speaker Type | | | |
| Connectivity | INPUT | VIDEO | (Basic) HDMI 2, (With Tray) HDMI 3 | |
| | | USB | (Basic) USB 1, (With Tray) USB 2, USB External (In/Out) 1 | |
| | OUTPUT | Touch Out | (Basic) Touch Out 1 (USB Upstream Type), Audio Out 1 (With Tray) Touch Out 2, Audio Out 1, Screen Share (HDMI-Out) 1 | |
| | | SENSOR | (Basic) Acceleration sensor (With Tray) Acceleration sensor, NFC | |
| | EXTERNAL | CONTROL | RS232C, LAN, WiFi/BT | |
| | Touch | Type | InGlass™ | |
| # of Drawing | | Multi writing up to 4 | | |
| Touch Pen Type | | Passive Pen with magnet | | |
| Object Recognition Range | | 2mm / 4mm / 8mm / 50mm, 1024 Level on Brush Mode | | |
| Touch Response Time | 6.7ms | | | |
| Power | Type | Internal | | |
| | Power Supply | AC100-240V 50/60Hz | | |
| | Power Consumption | Max (W/h) | 154 | 181.5 |
| | | Typical (W/h) | 80 | 100 |
| | | Rating (W/h) | 140 | 165 |
| | | Stand-by (W/h) | 0.5 | 0.5 |
| BTU (W/h) | 525.14 | 618.915 | | |
| Mechanical Spec | Dimension (mm) | Set | 1297.4(W) x 768.2(H) x 599(D) | 1522.4(W) x 897.6(H) x 62.9(D) |
| | | Package | 1464(W) x 915(H) x 190(D) | 1691(W) x 1055(H) x 198(D) |
| | Weight (kg) | Set | 28.2 | 40.0 |
| | | Package | 35.2 | 50.6 |
| | Colour | Light Gray | | |
| | VESA Mount | 400 x 400 | | |
| | Protection Glass | Yes | | |
| | Stand Type | Moving Stand, Wallmount | No-Gap Wall Mount | |
| | Rotation | Yes | N/A with Flip No-Gap Wallmount (Available with rotation support 3rd party accessory as sensor/portrait LUX already applied on Flip) | |
| | Power Cable Length | 3m | | |
| Accessory | Cover-Jack | | | |
| Operation | Operating Temperature | 0°C - 40°C | | |
| | Humidity | 10-80% | | |
| Feature | Key | Flip App | | |
| | Special | H/W | Super Clear Coating, Temperature Sensor, Pivot Display, Clock Battery (168hrs Clock Keeping), Built in Speaker (10W x 2), WiFi Module Embedded | |
| | | S/W | Flip S/W | |
| | | Platform | Muse-M (Tizen 5.0) | |
| | Internal Player (Embedded H/W) | Processor | CA72 Quad (1.7GHz) | |
| | | On-Chip Cache Memory | L1 (I/D) : 32KB / 32KB, L2 (Unified) : 1MB | |
| | | Clock Speed | 1.7GHz CPU Quad | |
| | | Main Memory Interface | LPDDR4.1.6GHz 64bit 2.5GB | |
| | | Graphics | 2D & 3D Graphics Engine - Up to 1920x1080. 32bpp - Supports OpenGL ES™ | |
| | | Storage | 8GB (2.65GB Occupied by O/S, 5.35GB Available) | |
| IO Ports | | USB 2.0 | | |
| Operating System | Samsung Proprietary OS (VDLinux) | | | |
| Accessories | Included | Passive Pen(2), Power Cable, Touch Out Cable (USB upstream) | | |
| | Optional | Stand | STN-WM55R | N/A |
| | | Wallmount | WMN4277SE | WMN-WM65R |
| | | Tray | CY-TF65BRC | CY-TF65BRC |
| | | Specialty | Flip LUX | Flip LUX |

For the latest news, please visit the Samsung Newsroom at news.samsung.com/ca/category/products/b2b. For more information about Samsung SMART Signage, visit www.samsung.com/ca/business or www.samsung.com/displaysolutions.

Copyright © 2020 Samsung Electronics Canada Inc. All rights reserved. Samsung is a registered trademark of Samsung Electronics Co. Ltd., used with permission. Specifications and designs are subject to change without notice. Non-metric weights and measurements are approximate. Screen images simulated. All brand, product, service names and logos are trademarks and/or registered trademarks of their respective manufacturers and companies and are hereby recognized and acknowledged.

2020-02

SAMSUNG

Cisco Webex